

Co series HCC

应用领域 Application

- 电动玩具
- 汽车电子
- 个人护理产品
- 电子烟、电子打火机
- Electric toy
- Automotive electronics
- Personal care products
- Electric cigarette, electronic lighter

性能特征 Characteristic

- 革命性防爆封装工艺，无泄漏，无重金属
- 放电平台高、安全性永远优越于传统锂电池
- 工作温度：-30~75℃
- 工作倍率：5~15C
- 循环寿命：0.5C 800次，1C>500次
- Revolutionary explosion-proof design, no leakage, no heavy metal
- High discharge platform, safer than traditional lithium battery
- Working temperature: -30~75℃
- Working rate: 5~15C
- Life Cycles: 0.5C 800 times, 1C>500 times

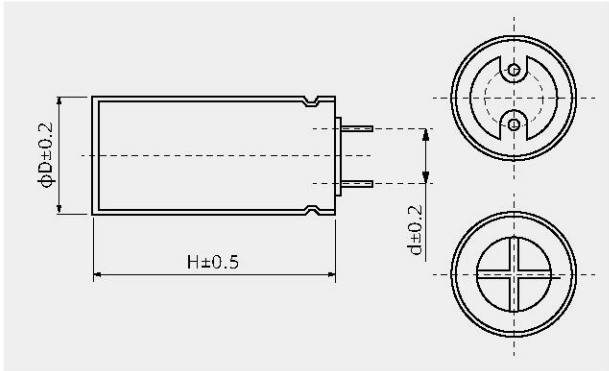

特征曲线图 Characteristic Graph

- 放电倍率特征曲线/Characteristic curve of discharge rate

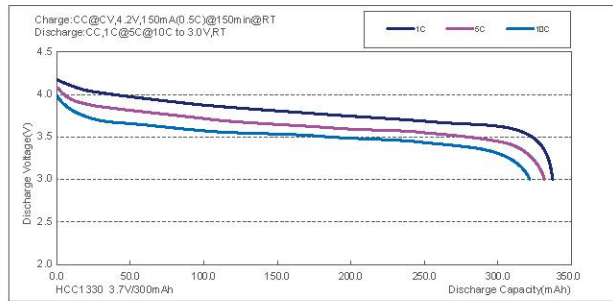

1C容量 1C capacity	5C容量 5C capacity	5C倍率比 5C ratio	10C容量 10C capacity	10C倍率比 10C ratio
mAh	mAh	%	mAh	%
337.4	331.5	98.3%	321.8	95.4%

- 高低温特征曲线
characteristic curve of high and low temperature

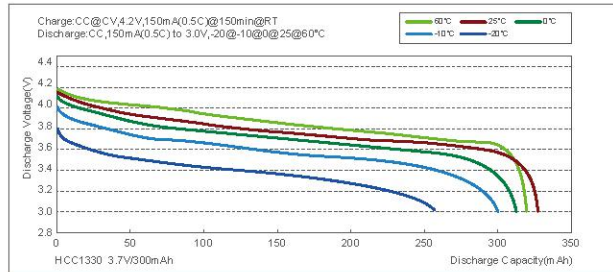

温度 tem perature	0.5C放电容量 0.5C discharge capact(mAh)	与25℃容量百分比 percentage of capacity at 25℃	温度 tem perature	0.5C放电容量 0.5C discharge capact(mAh)	与25℃容量百分比 percentage of capacity at 25℃
25℃	327.8	100.0%	0℃	312.5	95.3%
60℃	320.5	97.8%	-10℃	300.7	91.7%
			-20℃	268.5	81.9%

- 循环寿命特征曲线/Cyclic Life Characteristic Curve

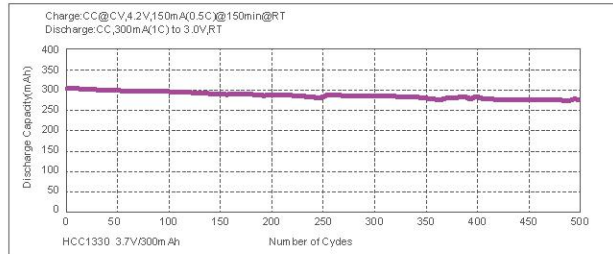

循环寿命	1C循环1周	50周	100周	150周	200周	250周	300周	350周	400周	450周	500周
容量(mAh)	303.5	299.3	293.9	289.9	286.2	281.8	285.4	281.1	280.3	276.8	275.2
百分比(%)	100.0%	98.6%	96.8%	95.5%	94.3%	92.9%	94.0%	92.6%	92.4%	91.2%	90.7%

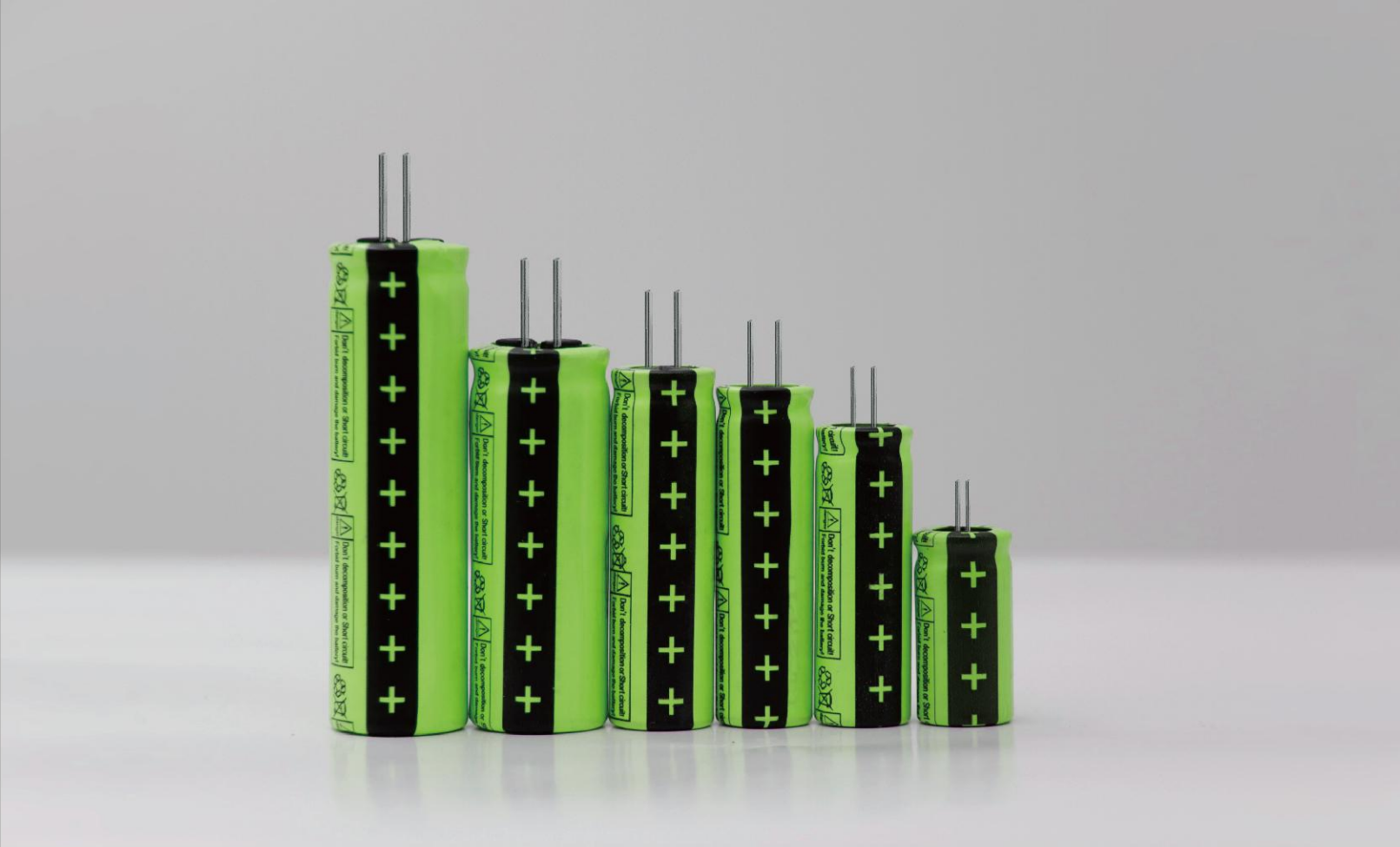

参数表 Parameter

型号 Model	标称容量 Capacity(mAh)	倍率 Rate	直径 Diameter(mm)	高度 Height(mm)	重量 Weight(g)	内阻 IR(mΩ)	标称电压 Voltage(v)
HCC6538	80	10C	6.5±0.15	38+0.5/-0	2.8	120	3.7
HCC7230	80	10C	7.2±0.15	30+0.5/-0	2.5	120	3.7
HCC7240	100	10C	7.2±0.15	40+0.5/-0	3.5	100	3.7
HCC0825	65	10C	8±0.15	25+0.5/-0	2.6	180	3.7
HCC0840	170	10C	8±0.15	40+0.5/-0	4.6	100	3.7
HCC0850	220	5C	8±0.15	50+0.5/-0	5.8	80	3.7
HCC0860	270	5C	8±0.15	60+0.5/-0	7.1	60	3.7
HCC1015	70	10C	10±0.15	15+0.5/-0	2.5	100	3.7
HCC1020	90	10C	10±0.15	20+0.5/-0	3.2	100	3.7
HCC1030	150	10C	10±0.15	30+0.5/-0	4.8	80	3.7
HCC1040	240	10C	10±0.15	40+0.5/-0	7.2	60	3.7
HCC1320	180	10C	13±0.15	20+0.5/-0	5.8	60	3.7
HCC1325	250	10C	13±0.15	25+0.5/-0	7.5	50	3.7
HCC1330	300	10C	13±0.15	30+0.5/-0	9.5	40	3.7
HCC1450	630	10C	14±0.15	50+0.5/-0	18.5	45	3.7